

This document is reference information about the products.  
Please confirm a document attached to a product definitely.

# CORT f HEPAMEDI HD Lotion

**Class-2 pharmaceutical product**    **Skin Emollient – Contains Heparinoid - Dermal Agent**

Cort f Hepamedi HD is a medicated lotion for the treatment of itchy scalp caused by dryness.

Cort f Hepamedi HD is applied directly to the itchy part of the scalp to relieve itching and inflammation, while the moisturizing ingredient heparinoid restores scalp health.

## ⚠ PRECAUTIONS

### ⊗ DON'Ts

**[Failure to follow these precautions may worsen the clinical condition or cause adverse reactions.]**

**1. Do not use if**

- (1) you have bleeding disorders (hemophilia, thrombocytopenia, purpura, etc.)
- (2) you may develop serious symptoms from even minor bleeds (Cort f Hepamedi HD may promote bleeding due to its anticoagulant effect)
- (3) you have atopic dermatitis (Even if your symptoms are mild, consult your doctor on the best course of treatment)



### CONSULT

**1. Consult a doctor, pharmacist or registered pharmacy before use if**

- (1) you are under the care of a doctor
- (2) you have ever had an allergic reaction to a medical product
- (3) you have severe weeping eczema or erosions
- (4) you have previously been diagnosed with atopic dermatitis.

**2. If any of the following symptoms occur after medication, they may be adverse reactions, so discontinue use immediately, and consult a doctor, pharmacist or registered pharmacy, showing this Package Insert:**

Affected area	Symptoms
Skin	rash/redness, itching, swelling

**3. If the symptoms are not alleviated after 5 to 6 days of treatment, discontinue use of medication, and consult a doctor, pharmacist or registered pharmacy, showing this Package Insert**

### INDICATIONS

Dry skin with itching (xeroderma in adults and the elderly, dry skin in children)

### DOSAGE AND ADMINISTRATION

Take an appropriate amount, and spread on the affected area once to several times a day.

### <Precautions of Dosage and Administration>

- (1) Strictly follow the DOSAGE AND ADMINISTRATION.
- (2) When allowing children to use the medicine, a guardian must be present to watch and tell such them how to take it.
- (3) Avoid contact with eyes. In case of which, rinse immediately with plain or lukewarm water. If the symptoms are severe, seek an ophthalmologist for medical treatment.
- (4) This medication is only for external use.

### Instructions for applying Cort f Hepamedi HD

- Before applying the lotion, open the cap with the applicator nozzle facing up then press down on the nozzle stopper a few times to remove any air from the tube.
- To apply the lotion to the affected area, face the applicator downwards or diagonally and gently squeeze the top of the tube. Be sure not to squeeze the tip or middle of the tube too firmly to prevent the lotion from spilling.

#### Before use

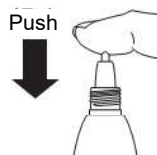

#### During use

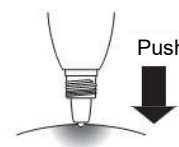

**COMPONENTS**

**Each 100 g contains:**

Ingredients	Amount	Purpose
Heparinoid	0.3 g	Promotes skin moisture retention
Diphenhydramine	1 g	Suppresses itching
Dipotassium glycyrrhizate	1 g	Relieves skin inflammation

Additives: macrogol, citric acid monohydrate, sodium citrate hydrate, polyoxyethylene polyoxypropylene cetyl ether, sodium chloride, paraben, povidone

**PRECAUTIONS FOR STORAGE AND HANDLING**

- (1) Store in a cool, low humidity place away from direct sunlight.
- (2) Keep out of reach of children.
- (3) Do not transfer the medicine to a different container. (It may lead to misuse or alter the quality of the drug.)
- (4) Be careful not to spill the lotion during use.
- (5) Take care to prevent the lotion from coming in to contact with metallic items such as wrist watches or glasses or with plastics, synthetic fibers, leather products or coated/painted floors or furniture (Cort f Hepamed HD may cause discoloration or deterioration of these items).
- (6) Cort f Hepamed HD lotion may cause discoloration of dyed or colored hair.
- (7) Do not use after the expiration date.



Distributed by **TANABE PHARMA CORPORATION**  
 3-2-10, Doshomachi, Chuo-ku, Osaka

Manufactured and distributed by **Japan Medic Co., Ltd.**  
 168 Yokogoshi Toyama-city, Toyama

**Correct understanding: Correct treatment**



The scalp of a healthy individual has sufficient moisture and elasticity to protect the body from external irritants such as allergens and micro-organisms. However, when the amount of sebum decreases due to lifestyle habits or exposure to the environment, the sebum barrier becomes thinner, thereby reducing the amount of moisture in the outermost layer of the epidermis and making the skin more susceptible to dryness. A dry scalp has reduced barrier function that makes the skin hypersensitive to even minor irritations, resulting in uncomfortable itching. Routine moisturizing is therefore essential to prevent these types of skin ailments.

**How to treat itchy scalp caused by dryness**

Reduced sebum production due to excessive shampooing or aging can cause scalp dryness accompanied by itching. Dry scalp may also be accompanied by fine, flaky dandruff. When this occurs, we recommend using Cort f Hepamed HD to restore the scalp's moisture. Cort f Hepamed HD soothes inflammation while its active ingredient heparinoid penetrates the scalp to retain moisture and moisturize the skin from the inside out, thereby preventing dryness and restoring scalp health.

